

THE REPRODUCTION, DISTRIBUTION AND UTILIZATION OF THIS DOCUMENT AS WELL AS THE COMMUNICATION OF ITS CONTENTS TO OTHER WITHOUT EXPLICIT AUTHORIZATION IS PROHIBITED. OFFENDERS WILL BE HELD LIABLE FOR THE PAYMENT OF DAMAGES. ALL RIGHT RESERVED IN THE EVENT OF THE GRANT OF A PATENT, UTILITY MODEL OR DESIGN. (PER ISO 15016)

REVISIONS			
REV	DESCRIPTION	DATE	APPROVED
D	REDRAWN - SUPERSEDES 1GA_FRB_ SHEET 2 REV."C" FOR 1GA20FRB20	12-8-95	EN-F16102 DP-24900

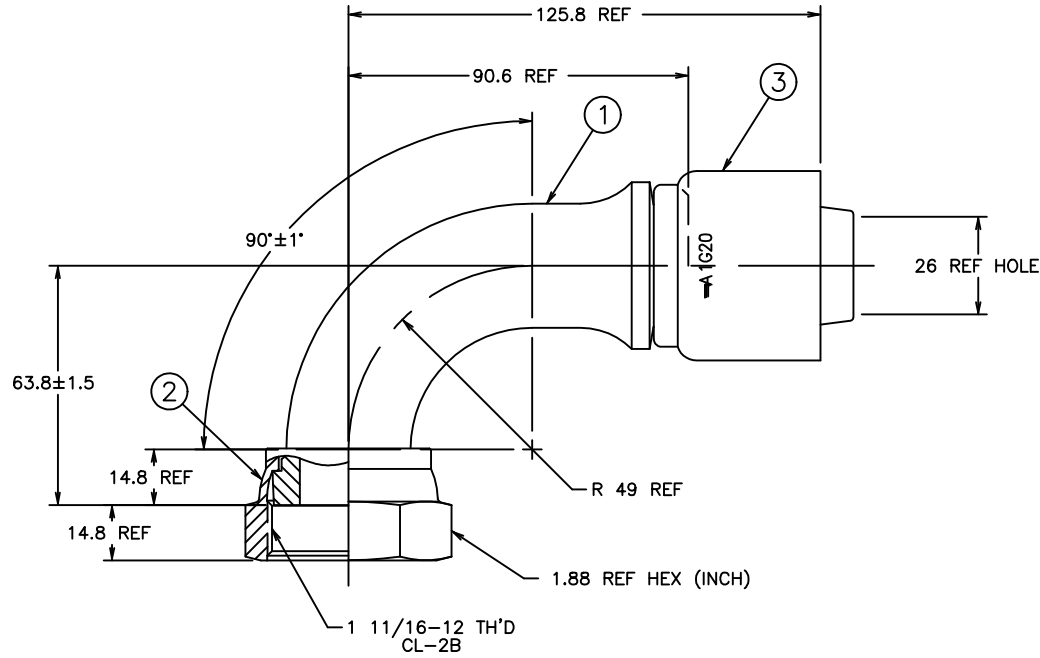

125.8	4.95
90.6	3.57
63.8±1.5	2.51±.06
49	1.93
26	1.02
14.8	.58
MM	INCH

CONVERSION

METRIC

ITEM NO.	MATERIAL	DESCRIPTION	QTY
1	STEEL	NIPPLE	1
2	STEEL	NUT	1
3	STEEL	SOCKET	1

1GA20FRB20	1F40023-2020AB	FC1473-20S	1G20
AEROQUIP PART NUMBER	① NIPPLE	② NUT	③ SOCKET

LIST OF MATERIALS			
DRAWN	M MOLINA	FLUID CONVEYANCE DIVISION DRAWING TITLE FITTING ASSEMBLY 90°, ORS FEMALE SWIVEL, OTC	
CHECKED	R.D.GARRETT		
APPROVED	R.D.GARRETT		
RELEASE DATE	12-8-95		
EN-F16102 DP-24900	SIZE C	DRAWING NUMBER	1GA20FRB20
THIRD ANGLE PROJECTION	SCALE 1/1	DIST U	CAGE CODE 01276 SHEET NO

2. 1SA20FRB20 NIPPLE ASSEMBLY MAY BE SUBSTITUTED FOR ITEMS #1 AND #2.

1. PROCESS AS FOLLOWS:
- BEND NIPPLE TO DIMENSIONS SHOWN.
 - ZINC PLATE PER ACES 2751.
 - CRIMP NUT PER ACES 2409P1.
 - ASSEMBLE SOCKET PER ACES 2813.