

REVISIONS			
REV	DESCRIPTION	DATE	APPROVED
C	REACTIVATED AS PER REV "A" TO SHOW AEROQUIP DESIGN	2006-05-12 RHJ/KBM	EN-F30034 DP-1299
D	ADDED MARKING FOR CRIMP LOCATION. UPDATED DRAWING ACCORDINGLY 1) ADDED NOTE #4 2) ADDED DIMENSION 3) WAS $\phi 9.6$ [.38] REF HOLE	2021-11-17 ARK	CO-0221252

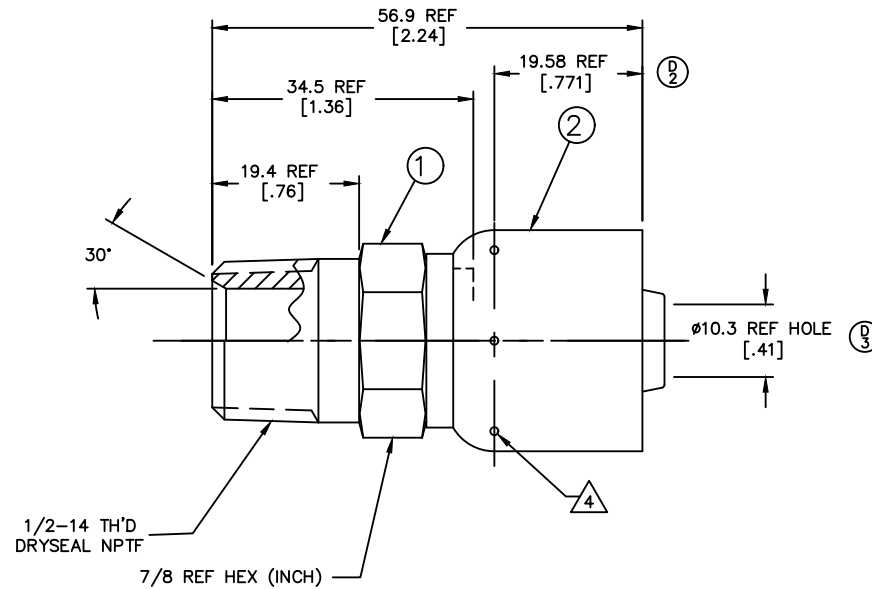

METRIC

4. CRIMP LOCATION IMPRESSION MARK (6-8 PLACES). (D)

3. DIMENSIONS ARE IN MILLIMETERS [INCHES].

2. THERE SHOULD BE NO SOCKET MOVEMENT ON THE NIPPLE AFTER CRIMPING.

1. CRIMP SOCKET PER ES 2409P17.

FJ3152-0810S	FW1260-0810S	FW1186-10S			
AEROQUIP PART NUMBER	(1) NIPPLE	(2) SOCKET			
LIST OF MATERIALS					
ITEM NO.	MATERIAL	DRAWN LaTanya Wraggs	FLUID CONVEYANCE DIVISION		
1	STEEL	CHECKED R. D. WEBB	DRAWING TITLE FITTING ASSEMBLY MALE PIPE, 1503 HOSE		
2	STEEL	APPROVED R.D.GARRETT			
		RELEASE DATE 2000-05-23	SIZE A2	DRAWING NUMBER FJ3152-0810S	REV D
		EN-F19881 DP-1290	SCALE 2/1	DIST U	CAGE CODE 01276
		THIRD ANGLE PROJECTION	SHEET 1		
<small>THE REPRODUCTION, DISTRIBUTION AND UTILIZATION OF THIS DOCUMENT AS WELL AS THE COMMUNICATION OF ITS CONTENTS TO OTHERS WITHOUT EXPLICIT AUTHORIZATION IS PROHIBITED. OFFENDERS WILL BE HELD LIABLE FOR THE PAYMENT OF DAMAGES. ALL RIGHT RESERVED IN THE EVENT OF THE GRANT OF A PATENT, UTILITY MODEL OR DESIGN. (PER ISO 16016)</small>					